



*AWE is a South Australian based consulting firm providing sustainable and innovative engineering, water resources, planning and natural resource management solutions for the community and our clients. Our team of professional and support staff has strong technical capabilities in hydrogeology, hydrology, civil and environmental engineering, integrated water resources management, groundwater modelling, ecology, spatial services, environmental management and planning, consultation and community engagement and data management.*

*Professional, independent land and water solutions benefiting people and the environment.*

**AWE Capabilities:**

- Hydrogeology
- Hydrology
- Civil Engineering**
- Environmental Engineering
- Integrated Water Resources Management
- Groundwater Modelling
- Ecology
- Spatial Services
- Environmental Management
- Statutory Planning
- Environmental Planning
- Consultation and Community Engagement
- Data Management

# Land Development and Subdivision

*Our capabilities include:*

- *Masterplanning;*
- *Infrastructure preliminary design;*
- *Site grading and earthworks design;*
- *Services stormwater and road design;*
- *Sewer design to SA Water Level 1 accreditation;*
- *Water main design to SA Water accreditation;*
- *Stormwater masterplanning;*
- *Soil erosion and stormwater management plans;*
- *Technical specifications;*
- *Pre-tender cost estimates;*
- *Tendering contract administration & superintendence;*
- *Authority liaison & approvals;*
- *Land development feasibility studies.*



1/198 Greenhill Road  
Eastwood SA 5063

P: (08) 8378 8000  
F: (08) 8357 8988

W: [www.austwaterenv.com.au](http://www.austwaterenv.com.au)

*For more information please contact:*

**Geoff Fisher**  
*Director*

Ph: (08) 8378 8000  
Email: [geofffisher@austwaterenv.com.au](mailto:geofffisher@austwaterenv.com.au)



## Sustainable Residential Subdivision Design Fact Sheet Series, Mt Barker

AWE, in conjunction with Jensen Planning & Design, developed a sustainable residential subdivision design fact sheet series for the District Council of Mt Barker. AWE's role was to develop the WSUD fact sheet. This included a Water Sensitive Urban Design fact sheet.

## Port Augusta Infrastructure Plans and Port Augusta West Residential Subdivision

AWE prepared stormwater, potable water, wastewater and electrical infrastructure headworks plans to inform the future development of the City of Port Augusta. This included masterplanning and preliminary design of a 390 hectare residential subdivision abutting the airport.



## Northern LeFevre Peninsula Infrastructure Headworks

AWE undertook the detailed planning of infrastructure headworks comprising stormwater, wetland and Managed Aquifer Recovery investigations.

Staff from AWE undertook detailed planning of all transport infrastructure, site grading, water and wastewater infrastructure and services infrastructure including an innovative pressure sewer system.

## Tangaloona Country Estate, Jamestown

AWE undertook the detailed design and documentation of all site grading, stormwater and civil works for a 90 unit retirement village.

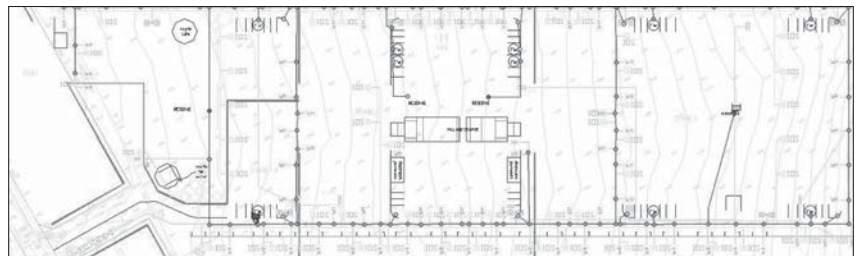

## Dunfield Estate, Mt Torrens

AWE undertook concept design and masterplan for a new 47 lot ecological sustainable residential development at Mt Torrens.

## Para Road, Evanston

AWE undertook concept and detailed design of site grading roads and all infrastructure and development approval application for a 20 lot subdivision.

## Hindmarsh Island, Residential Subdivision

AWE undertook masterplanning and initial stormwater and wastewater masterplanning on two subdivisions.

## Eco Beach and Rivoli Point, Land Feasibility Study

AWE undertook a coastal erosion, inundation, biodiversity and infrastructure feasibility assessment of land abutting the coast to determine the potential suitability for eco-tourism development.